



PENETRATOR™

No. 1618

Large Payload Tube
11514

Nose Cone
20308

ASSEMBLY INSTRUCTIONS

TOOLS YOU'LL NEED TO ASSEMBLE THIS ROCKET

Tube Type Plastic Cement

Hobby Knife

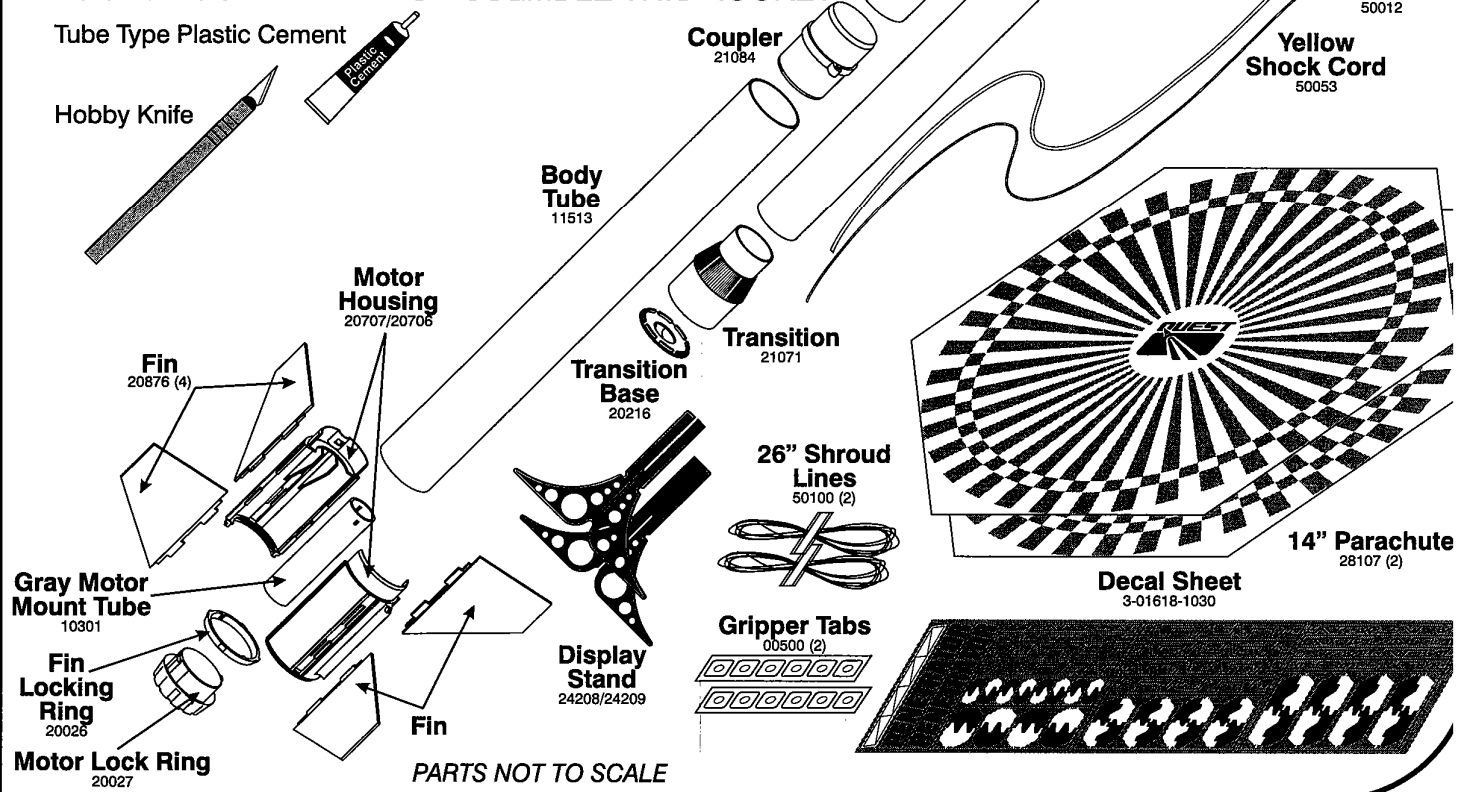
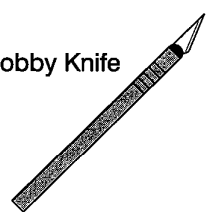

PARTS NOT TO SCALE

1

Yellow Kevlar Shock Cord

White Elastic Shock Cord

A. Hold the Yellow and White Cords side by side with the ends even.

B. Tie an over-hand knot to join the cords.

C. Pass Yellow Cord through loop in Motor Housing.

D. Tie a double knot.

2

Plastic Cement

A. Position slot in Gray Motor Mount Tube over tab on Motor Housing.

B. Glue the two Motor Housing halves together.

C. Feed Yellow and White Cord through the Body Tube.

D. Apply glue around inside of Body Tube and insert Motor Housing until it seats against the Body Tube.

3

A. Test fit all four Fins into the slots.

B. Remove each one, add glue and replace.

C. Twist Fin Locking Ring onto rear of Motor Housing.

D. Tie a figure "8" knot in the loose end of the White Shock Cord with a 1 inch loop as shown.

Check Fin alignment

4

A. Apply Glue around inside edge of Transition.

B. Push Transition Base into Transition.

C. Apply glue around inside edge of Small Payload Tube and push Transition into place.

D. Position Nose Cone in end of Tube. DO NOT GLUE!

E. Apply Glue around inside edge of Body Tube and push Coupler into place.

F. Apply Glue around inside edges of Large Payload Tube. Push Tube onto Coupler.

Align launch lug between fins with lug in coupler

5

Repeat A-C for second Parachute

A. Place one Gripper Tab on each of the six corners on Parachute.

B. Firmly squeeze each Gripper to the Parachute with your fingers.

C. Tie Shroud Line with a double knot.

D. Attach ONE Parachute to eyelet in Coupler Base.

E. Attach ONE Parachute to loop in White Shock Cord.

6

A. Grab Parachute at center - pull gently.

B. Fold.

C. Roll.

D. Insert rolled Parachutes, then Shock Cord and slide Payload section in place.

PARACHUTES MUST SLIDE EASILY INTO THE TUBE.

7

A. Remove the self-adhesive decals one at a time.

B. Position on rocket.

C. Rub gently.