

MODEL: BLACKOUT™ XBE PRO



BLACKOUTTM XBE PRO

1/10 SCALE TRAIL BUGGY
OWNERS MANUAL



FAST · AFFORDABLE · FUN™

MAN-BLACKOUTXBEPRO-2016.4.19

- To ensure that you are using the most recent version of this manual:
<http://www.redcatracing.com/manuals/BLACKOUTXBEPROMANUAL.pdf>
- To ensure that you have the most recent version of the Electronic Vehicles Manual:
www.redcatracing.com/manuals/ELECTRIC-MANUAL.pdf

WARNING!

READ ALL INSTRUCTIONS INCLUDED WITH VEHICLE BEFORE OPERATING

**AGE WARNING!**

This radio controlled (RC) vehicle is not a toy! You must be 14 years of age or older to operate this vehicle. Adult supervision is required.

**RISK OF RUNAWAY VEHICLE OR INJURY!**

Never turn on the vehicle or plug in the battery pack without first having the controller turned on.

**RISK OF FIRE! / RISK OF EXPLOSION!**

There is a risk of fire and explosion when dealing with batteries. Rechargeable batteries may become hot and catch fire if left unattended or charged too quickly. Use extra caution when charging LiPO batteries. Use only LiPO specific chargers. Use a LiPO safe charging pouch when charging LiPOs. Charge away from flammable materials. Never charge at a rate higher than 1C. {2000Mah pack= 2amps charge rate). Overcharging can lead to fire and explosion. Always store battery packs in a cool dry place.

**RISK OF BURNS!**

The batteries, electronic speed controller (ESC), electric motor, and other areas of the vehicle can get hot. Burns can occur if touched after vehicle operation. Allow adequate time to cool before handling.

**RISK OF ELECTRICAL SHOCK!**

Use caution when charging batteries. Do not touch positive and negative leads together. Do not lay battery on metal. Use only chargers specified for the battery type being charged. Keep batteries and chargers away from water.

**RISK OF INJURY!**

Hobby grade RC vehicles can cause serious injury or death if not operated correctly. Never use vehicle in crowds. Never chase people or animals. Drive in safe open areas only. Keep body parts away from moving parts.

**RISK OF DAMAGE!**

Never operate RC vehicles on public roads. Damage of vehicle and property can occur. Only operate on open private property. Never charge the battery pack while it is still plugged into the RC vehicle. Always unplug the battery pack from the electronic speed controller (ESC) and remove the battery from the RC vehicle before charging. Failure to do so will result in damage to the vehicle's electronics.

**WARNING!**

Do not mix old and new batteries. Do not mix alkaline, lithium, standard (carbon zinc), or rechargeable (nickel cadmium) batteries. Do not change or charge batteries in a hazardous location.

**FCC Compliance Statement!**

The radio included with your vehicle complies with part 15 of the FCC Rules. Operation is subject to the following two conditions: (1) This device may not cause harmful interference, and (2) This device must accept any interference received, including interference that may cause undesired operations. Note: This equipment has been tested and found to comply with the limits for a Class B digital device, pursuant to Part 15 of the FCC Rules. These limits are designed to provide reasonable protection against harmful interference in a residential installation. This equipment generates, uses and can radiate radio frequency energy and, if not installed and used in accordance with the instructions, may cause harmful interference to radio communications. However, there is no guarantee that interference will not occur in a particular installation. If this equipment does cause harmful interference to radio or television reception, which can be determined by turning the equipment off and on, the user is encouraged to try to correct the interference by one of the following measures:

Reorient or relocate the receiving antenna.

Increase the separation between the equipment and receiver.

Connect the equipment into an outlet on a circuit different from that to which the receiver is connected.

Consult the dealer or an experienced radio/TV technician for help.

WARNING: Any changes or modifications not expressly approved by the party responsible for compliance could void the user's authority to operate this equipment.

WARNING: While operating the Radio, a separation distance of at least 20 centimeters must be maintained between the radiating antenna and the body of the user or nearby persons in order to meet the FCC RF exposure guidelines.

FEATURES & SPECIFICATIONS

- Brushless Electric Motor
 - Waterproof Brushless ESC LIPO Ready
 - Forward & Reverse
 - 4 Wheel Drive
 - Oil Filled Shocks
 - 7.4v LIPO Battery
 - LIPO Battery Charger
 - 2.4GHz Radio System
 - Waterproof Steering Servo
- Scale: 1/10
 - Length: 427mm
 - Width: 280mm
 - Height: 140mm (Without Body)
 - Wheelbase: 290mm

VEHICLE OVERVIEW

- A: Oil Filled Shocks
- B: Steering Servo
- C: Battery
- D: Center Drive Shaft
- E: On/Off Switch
- F: 2.4GHz Receiver
- G: ESC
- H: Electric Motor
- I: Steering Linkage
- J: Upper Suspension Link
- K: Rear Toe In/Out Link
- L: Battery Door

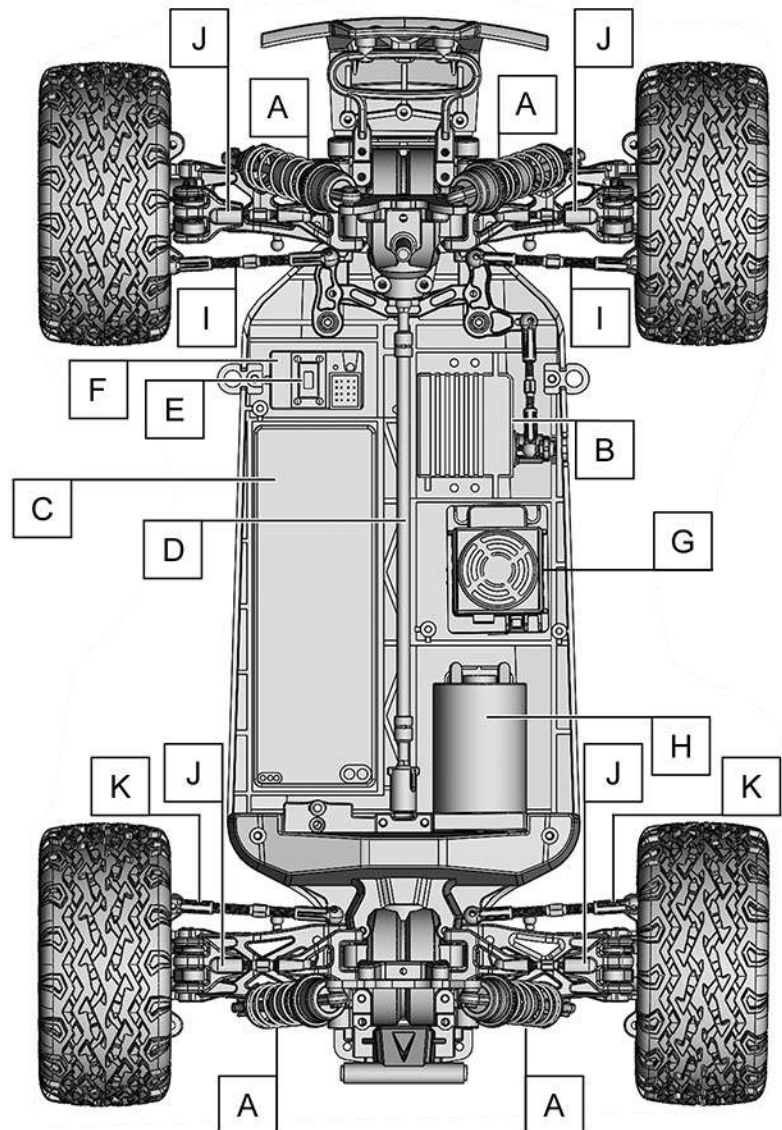
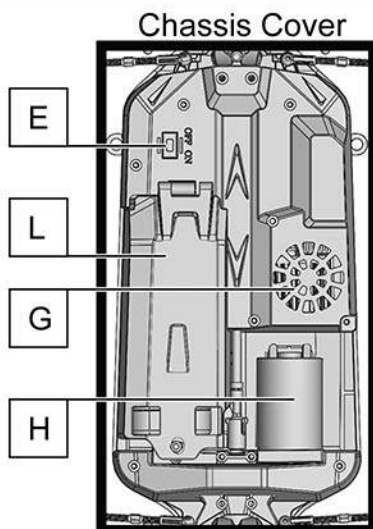

HINGED BODY

Accessing the ON/OFF Switch:

1. To access the ON/OFF switch, remove a single body clip (A) found on the hood of the vehicle. The ON/OFF switch (B) is accessible without removing the dust cover.

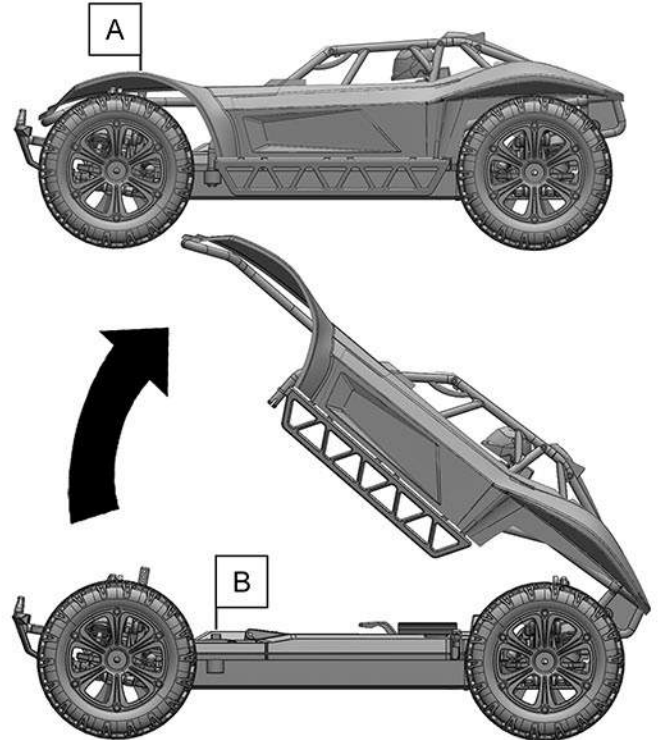
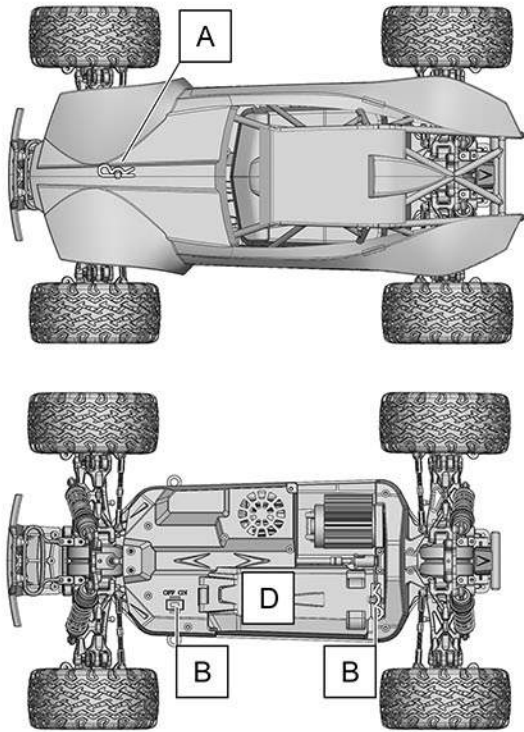

Accessing the Battery:

1. Remove the clip (C) at the rear of the battery door (D).
2. Raise the rear of the battery cover (D) to swivel it upward, revealing the battery (E).

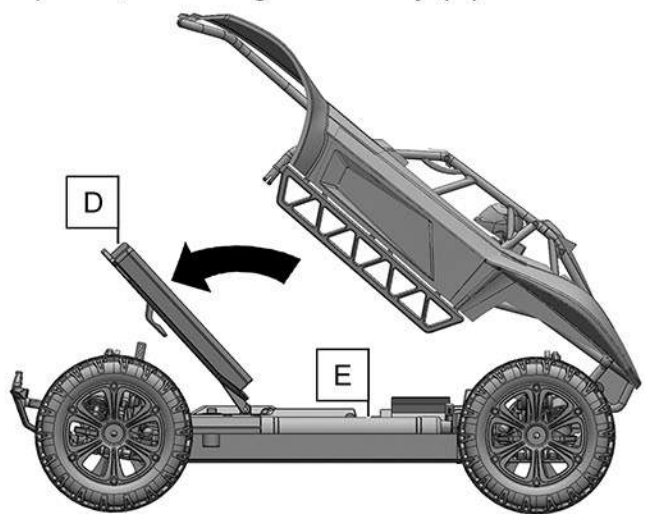
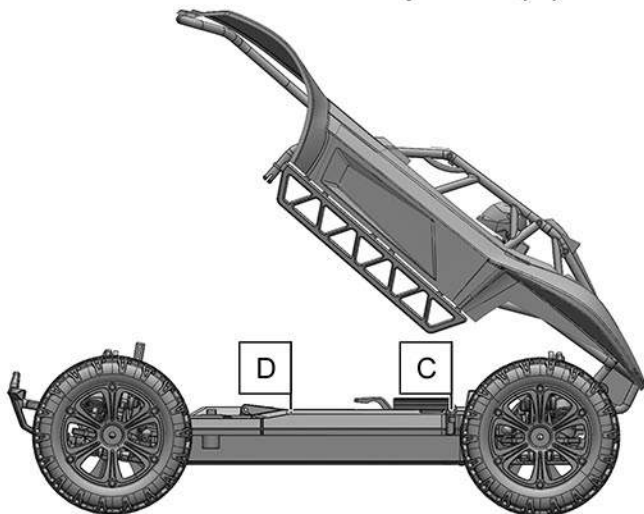

Chassis Dust Cover:

If you would like to access all the electronics and main chassis, removing the dust cover is easy. Just remove the body clips holding it down, it is now ready for removal.

RADIO GUIDE

CONTROL PANEL

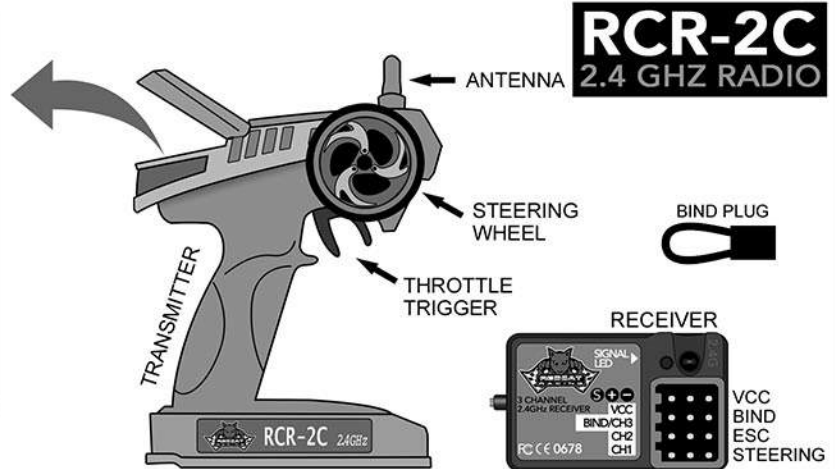

Steering Reverse Switch: Top left switch. Used to change steering orientation. If the car turns right when you steer left, flip this switch.

Throttle Reverse Switch: Top right switch. Used to change throttle trigger orientation. If the car goes in reverse while you pull the throttle trigger, flip this switch.

Power LED: Left LED light. Lights up when the transmitter is turned on.

Battery Level LED: Right LED light. Lights up green when transmitter batteries are full. Flashes when transmitter batteries are low and need replacing.

Bind Button: Used to bind the transmitter to the receiver. See binding instructions.

Steering Trim: Left knob. Used to set the steering neutral point. If the vehicle veers in one direction while the steering wheel is centered, turn this knob in the opposite direction until the car drives straight.

Throttle Trim: Middle knob. Used to set the throttle neutral point. If the vehicle moves forward or reverse while the throttle trigger is centered, turn this knob until the vehicle remains still. For maximum setting, turn slowly until the vehicle creeps forward, then turn the knob the opposite direction until the car stops.

Steering Dual Rate: Right knob. Used to limit the amount of steering. 0= little/no steering & 6= maximum steering. Set the knob to the amount of steering you feel comfortable with. If the vehicle has a tendency to spin out, lower the steering rate.

On/Off Switch: Bottom switch. Turns transmitter On and Off.

VCC: Not used.

Bind/Ch3: Used when binding to transmitter. Used for 3rd channel when needed.

Ch2: Used for Electronic Speed Controller.

Ch1: Used for steering servo.

Binding:

1. Insert the BIND PLUG into the receiver BIND port.
2. Make sure your ESC is plugged into CH2, and insert the bind plug into BIND/CH3. Now, power the vehicle on and the receiver light should begin to blink red.
3. Press the BIND button in the center of the transmitter's Control Panel and turn on radio.
4. Release the bind button when you see the green light on the radio flashing. At this point, your receiver's LED should now be solid red. Turn off the power to your vehicle, as well as the radio.
5. Remove the BIND PLUG from the receiver. Make sure the servos and ESC are attached as described above.
6. First turn your radio on, then your vehicle as normal. Your radio and receiver should be bound together and communicating with each other.

CHARGERS

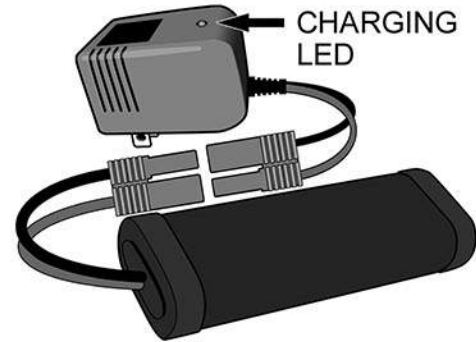
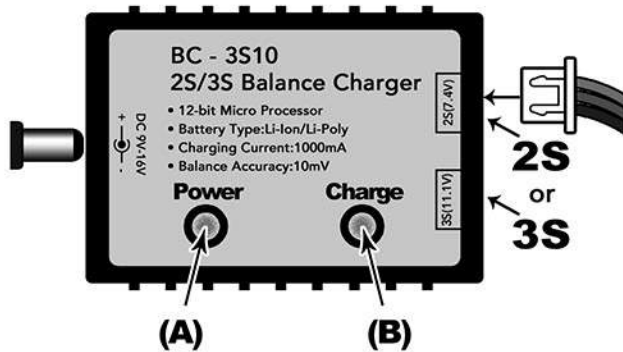

LIPO: The BC - 3S10 Balance charger is capable of charging 2S and 3S LIPO batteries.

DC PORT: Single round port on left end of charger. Plug in DC adapter here.

POWER LED: Left LED light. Lights up when charger is connected to a 110v power source.

CHARGE LED: Right LED light. Blinks while battery is charging. LED light will turn solid red when battery is fully charged

2S PORT: Used to charge 2S 7.4v LIPO battery packs.

3S PORT: Used to charge 3S 11.1v LIPO battery packs.

CHARGING INSTRUCTIONS:

1. Unplug the battery pack from the ESC and remove the battery from the vehicle.
2. Plug the charger into a 110v power receptacle using the included DC power adapter.
 - Power light will be on.
3. Plug the 2S/3S LIPO battery "balance charge plug" into the appropriate charge port. (as seen above) - Charge light will blink while the LIPO battery is charging.
4. When the charge light turns solid red, unplug the battery as charging is complete.
5. Unplug charger from the 110v power source.

NIMH: Charging NiMh battery packs with the included charger is very simple.

1. Plug the charger into a 110v wall receptacle.

ATTENTION

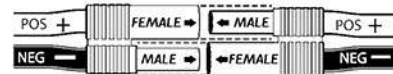

Ensure POS+ wire is connected to POS+ & NEG- is connected to NEG-

2. Plug the battery pack into the charger.
3. Red light indicates the battery is charging.
4. Battery takes 8 hrs to completely charge.



WARNING



UNPLUG THE BATTERY PACK FROM THE VEHICLE!

BEFORE CHARGING YOUR BATTERY PACK, YOU MUST FIRST UNPLUG IT FROM THE ESC. FAILURE TO UNPLUG THE BATTERY FROM THE VEHICLE'S ESC BEFORE CHARGING MAY PERMANENTLY DAMAGE SOME OR ALL ELECTRONICS IN THE VEHICLE.

NEVER LEAVE BATTERY PACKS UNATTENDED WHILE CHARGING! Leaving a battery unattended while charging may result in fire and damage / injury.

NEVER ALLOW A BATTERY PACK TO GET HOT! It's normal for the battery pack to get warm, but it should never get hot! Monitor batteries during charging and unplug to let cool if the battery gets hot.

WHEN CHARGING LIPOs, A LIPO SAFE CHARGING BAG SHOULD BE USED TO HELP PREVENT FIRES.

BLACKOUT XBE PRO
EXPLODED VIEW

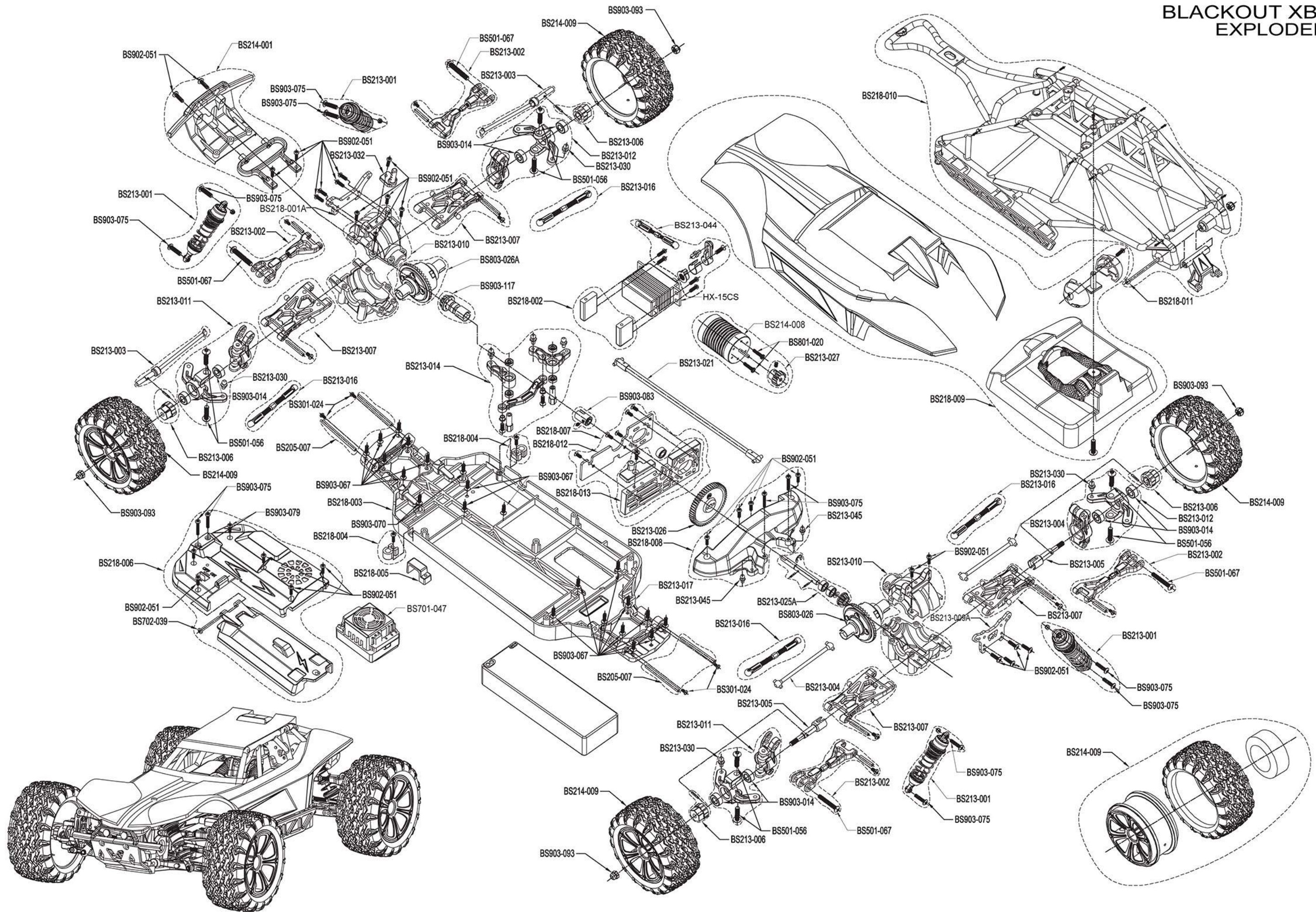

PARTS IDENTIFICATION



BS218-001A Fr. Brace

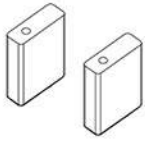

BS218-002 Servo mount 2pcs

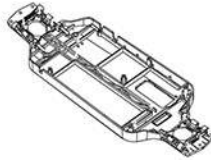

BS218-003 Chassis

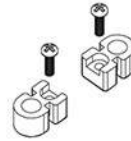

BS218-004 Support fixed block 2pcs

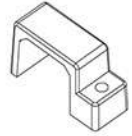

BS218-005 Wire Mount

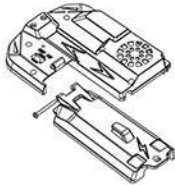

BS218-006 Upper Deck-Fr.

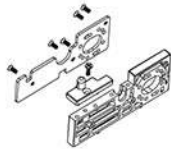

BS218-007 Motor Mount Unit

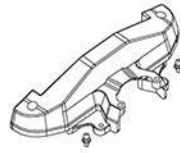

BS218-008 Gear Box Case Unit



BS218-009 Body

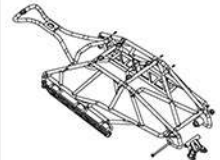

BS218-010 Body Mount



BS218-011 Screw 3*50 4pcs

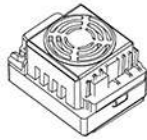

BS701-047 45A Brushless Waterproof Esc



BS218-019 Screw BT2*8 12pcs
BS218-020 Screw BT2*12 12pcs



BS213-001 Shock Unit 2pcs



BS213-002 Upper Susp. Arm Unit 2pcs



BS213-003 Front Transverse Drive Shaft w/axle 2pcs

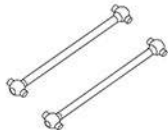

BS213-004 Rear Transverse Drive Shaft 2pcs

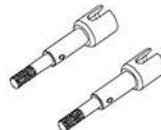

BS213-005 Rear Axle 2pcs

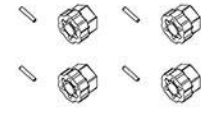

BS213-006 Rim Hub With Pin 4pcs

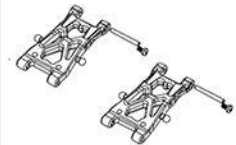

BS213-007 Lower Susp. Arm Unit 2pcs

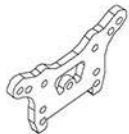

BS213-009A Rear Brace



BS213-010 Diff. Gearbox Bulkhead Upper/Lower



BS213-011 C Hubs Unit L



BS213-012 C Hubs Unit R



BS213-014 Steering System Unit



BS213-044 Servo Mount



BS213-016 Steering Link 4pcs



BS213-021 Drive Shaft Unit

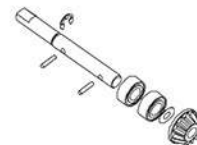

BS213-025A Gear Shaft unit



BS213-026 Spur Gear 55T

PARTS IDENTIFICATION



BS213-030 Ball Head Screw 12pcs
 BS213-045 B Head Hex Fine Pitch Screws M3 12pcs



BS213-032 Body Mount 2pcs

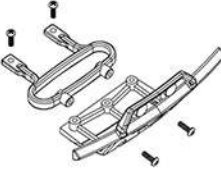

BS214-001 Bumper Unit



BS214-005 Motor Gear 17T



BS214-009 Tire Unit 2pcs



BS205-007 Pin 3*45 5pcs

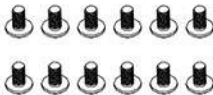

BS301-024 PWB2.5*5.7*5.5 Screw 12pcs



BS501-056 B head hex fine pitch screws HM4*12 12 pcs
 BS501-067 B head hex fine pitch screws HM4*22 12 pcs



BS702-039 Screw (BM3*30) 12pcs
 BS704-023 Screw (BM3*16) 12pcs
 BS801-020 Screw (BM3*12) 12pcs



BS902-051 Screw (BM3*10) 12pcs
 BS903-079 B-Head Cross Screw (BM3*10) 12pcs
 BS903-075 B-Head Cross Screw (BT3*16) 12pcs



BS214-008 540 Brushless Motor KV3800



BS903-014 Ball Bearing (φ6*φ12*4) 2pcs



BS803-026 Diff. Gear Box Unit(steel)



BS903-083 Diff. Outdrive D/set Screw



BS903-067 (TPF3*10) Flat Cross Screw 12pcs
 BS903-070 (ISO3*10) Flat Cross Screw 12pcs

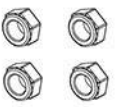

BS903-093 Nylon locknut (M4*4) 4pcs



HX-15CS 15kg Waterproof Servo



RCR-2CNR 2.4G Radio

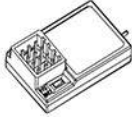

28479 2.4G Receiver

PARTS IDENTIFICATION

BS213-014 Steering System Unit

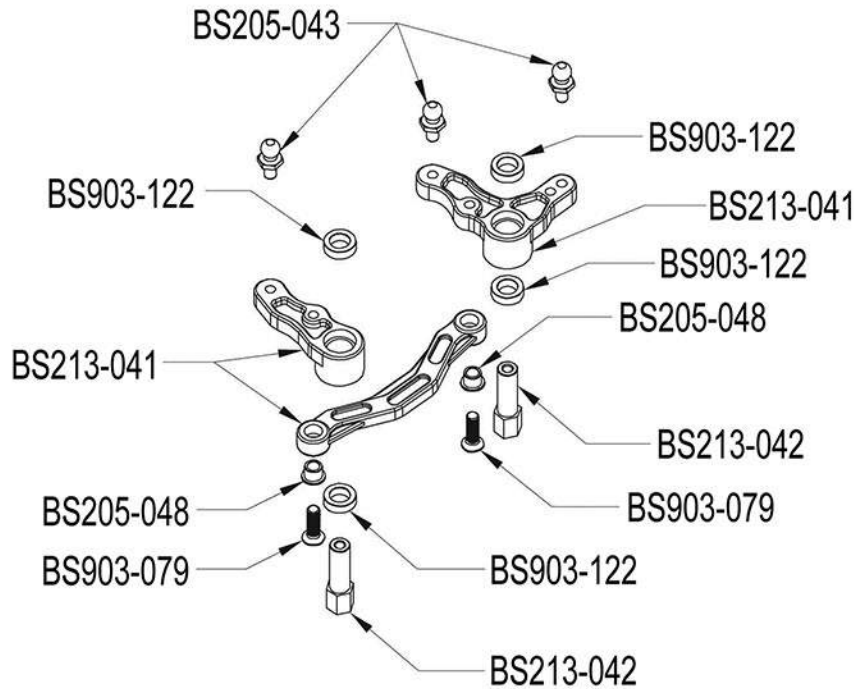

BS205-043 Ball head screw
4.8*12.3

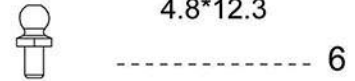

BS903-122 Copper bush
5.1*8*2.5



BS205-048 Spacer bush
3.05*3.7



BS903-079 B-Head Cross
Screw(BM3*10)



BS213-039 Steering Axis
(5*20.9)

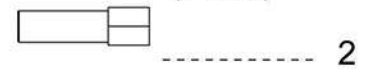

BS213-001 Shock Unit

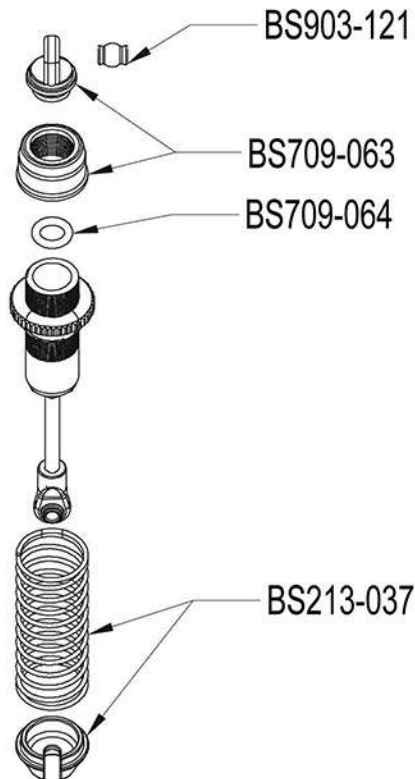

BS709-059 Spacer bush
3.6*5.9*1

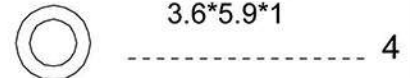

BS709-059 Shock Low
Cylinders



BS709-060 O Ring 6.5*3.5*1.5



BS709-061 O Ring 5*8*1.5



BS709-062 Shock Ball end



BS903-121 Shock ball head









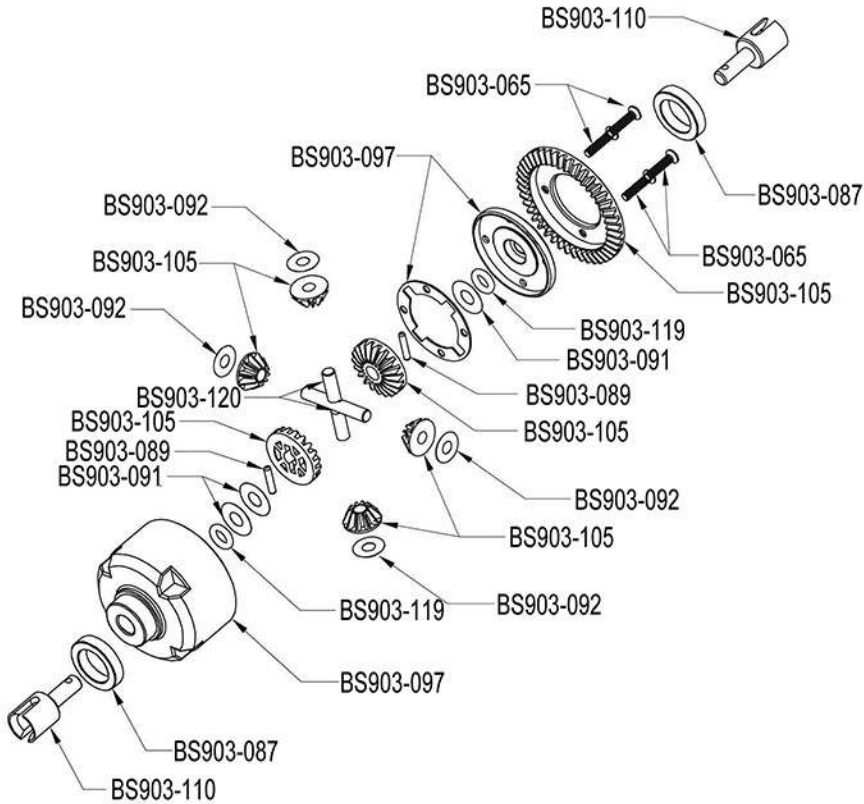

BS709-064 O Ring 6*10*2

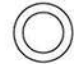

PARTS IDENTIFICATION





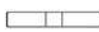

BS903-104 Diff Gear box unit

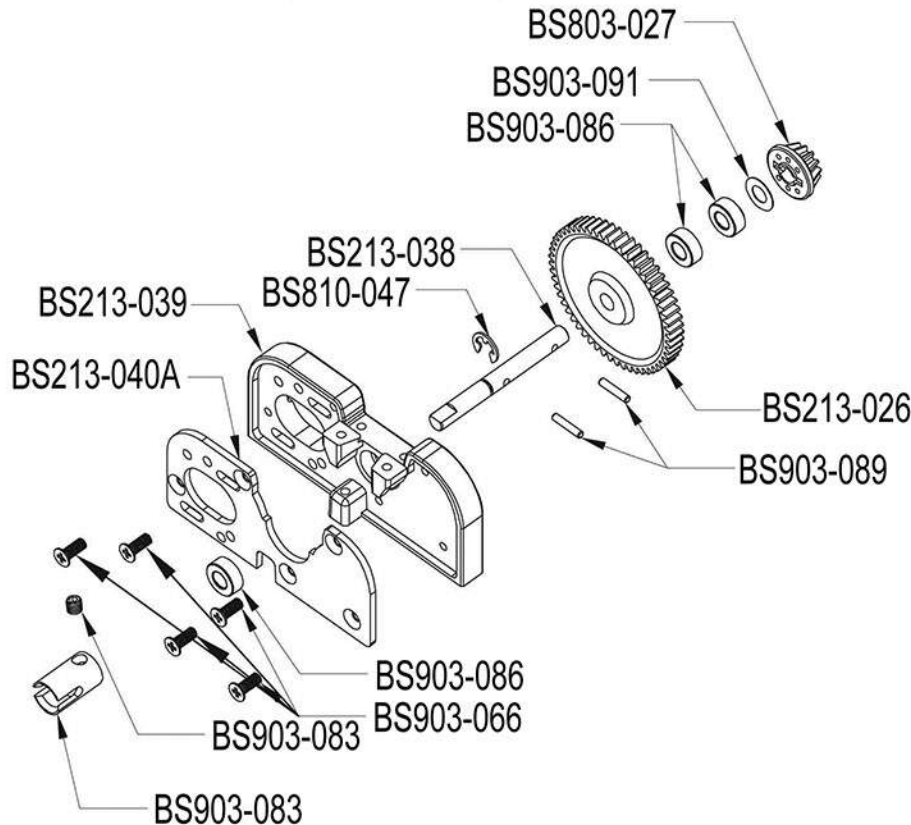

- BS903-110 Joint B  1
- BS903-087 Ball Bearing(12*18*4)  2
- BS810-038 B head hex fine pitch screws HM2.5*12  12
- BS903-119 O ring 5*9*2  12
- BS903-091 Washer A(5.2*10*0.2)  12
- BS903-092 Washer B(4.2*8*0.2)  12
- BS903-089 Pin(2*9.8)  12
- BS903-120 Diff Gear Shaft (4*26.2)  6

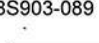
BS213-029 Spur Gear Unit(Zinc Alloy)



- BS903-091 Washer A (5.2*10*0.2)  12
- BS903-086 Ball Bearing 5*10*4  2
- BS903-089 Pin 2*9.8  12
- BS810-047 E clip  12
- BS213-038 Gear shaft  1
- BS903-066 Flat Cross Screw(TPF3*8)  12
- BS903-083 Joint D  1



FAST  AFFORDABLE  FUN

www.redcatracing.com

MAN-BLACKOUTXBEPRO-2016.4.19

- To ensure that you are using the most recent version of this manual:
<http://www.redcatracing.com/manuals/BLACKOUTXBEPROMANUAL.pdf>
- To ensure that you have the most recent version of the Electronic Vehicles Manual:
www.redcatracing.com/manuals/ELECTRIC-MANUAL.pdf